

2022 Lexus IS 500 RWD V8-5.0L (2UR-GSE)

Vehicle > Steering and Suspension > Suspension > Suspension Strut / Shock Absorber > Service and Repair > Removal and Replacement

REAR SHOCK ABSORBER - REMOVAL [09/2020 -]

REAR SUSPENSION: REAR SHOCK ABSORBER: REMOVAL; 2021 - 2023 MY IS200T IS250 IS300 IS350 IS500 [09/2020 -]

CAUTION / NOTICE / HINT

HINT:

- Use the same procedure for the RH side and LH side.
- The procedure listed below is for the LH side.

PROCEDURE

1. REMOVE LUGGAGE COMPARTMENT TRIM COVER

Click here [[DOOR / HATCH: LUGGAGE DOOR HINGE TORSION BAR: REMOVAL+](#)]

2. REMOVE REAR WHEEL

Click here [[TIRE / WHEEL: TIRE AND WHEEL: REMOVAL](#)]

3. SEPARATE TOE CONTROL LINK SUB-ASSEMBLY

- a. Remove the nut.

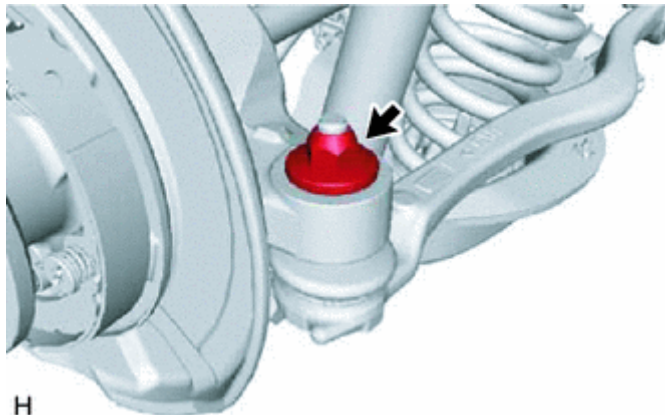

- b. Install 2 spacers (SST spacer B) as shown in the illustration.

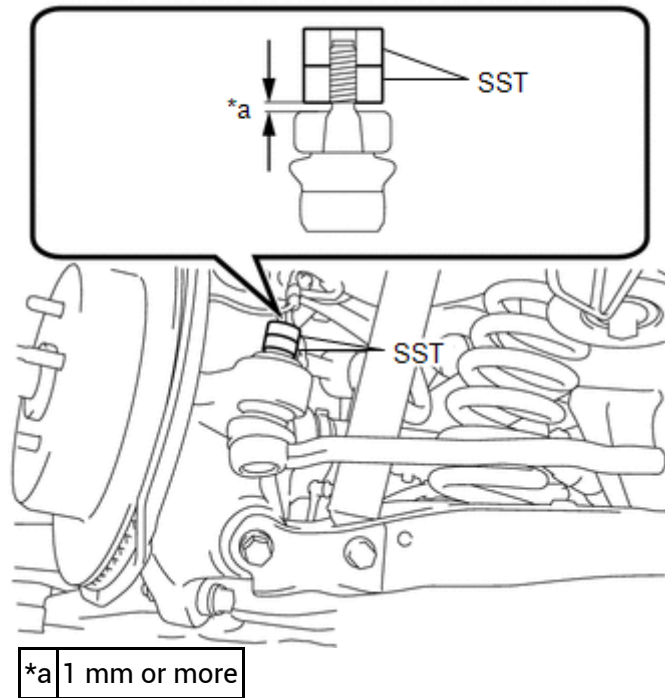



SST : 09960-20010

09961-02060

NOTICE:

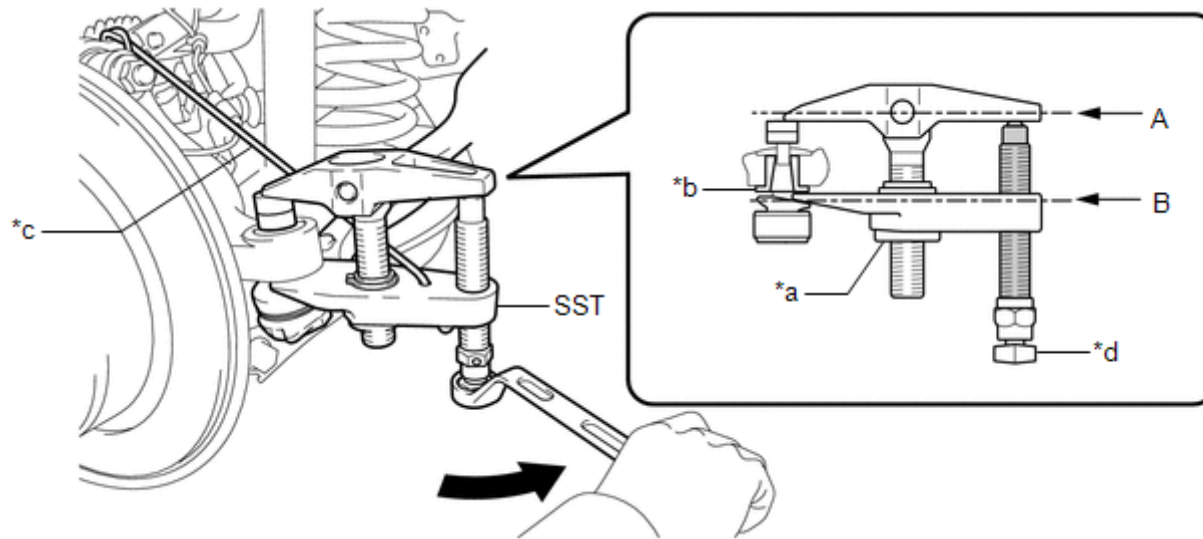
- As SST may be damaged, make sure that the clearance between the rear axle assembly and spacers is 1 mm (0.0394 in.) or more.**
- c. Using SST, separate the toe control link sub-assembly from the rear axle assembly as shown in the illustration.



*a	Nut	*b	Spacer
*c	Tie string without any slack	*d	Place wrench here
	Turn		Molybdenum Grease

SST : 09960-20010

09961-02010

09961-02060

CAUTION:

Apply molybdenum grease to the threads and end of the SST bolt.

NOTICE:

- Install SST so that A and B are parallel.
- Be sure to place the wrench on the part indicated in the illustration.
- Be sure to tighten the string firmly to secure SST to the rear upper control arm assembly to prevent SST from falling off.
- Do not damage the toe control link sub-assembly ball joint dust cover.
- Make sure that SST is securely positioned on the spacer.
- If the spacer has come off, replace the rear axle carrier sub-assembly with a new one.

4. REMOVE ABSORBER CONTROL ACTUATOR (w/ AVS)

Click here [[SUSPENSION CONTROL: ABSORBER CONTROL ACTUATOR \(for Rear Side\): REMOVAL+](#)]

5. REMOVE REAR SHOCK ABSORBER ASSEMBLY

a. Support the rear No. 2 suspension arm assembly using a jack and wooden block.

NOTICE:

- When jacking up the rear No. 2 suspension arm assembly, be sure to jack it up slowly.
- Make sure to perform this operation with the vehicle kept as low as possible.
- Keep supporting the rear No. 2 suspension arm assembly with a jack until the installation of the rear shock absorber assembly has been completed.

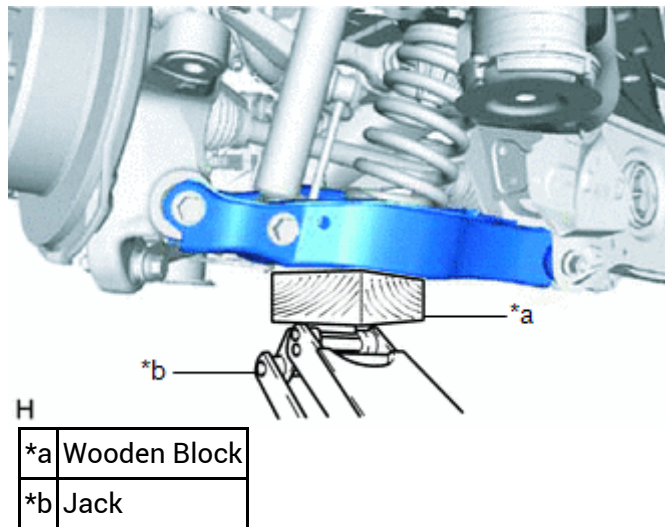

b. Remove the bolt and nut, and separate the rear shock absorber assembly from the rear No. 2 suspension arm assembly.

NOTICE:

Because the nut has its own stopper, do not turn the nut. Loosen the bolt with the nut secured.

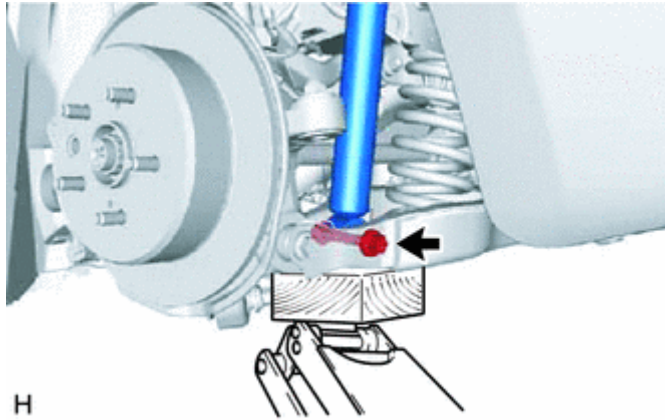

c. Remove the 3 nuts and rear shock absorber assembly from the vehicle.

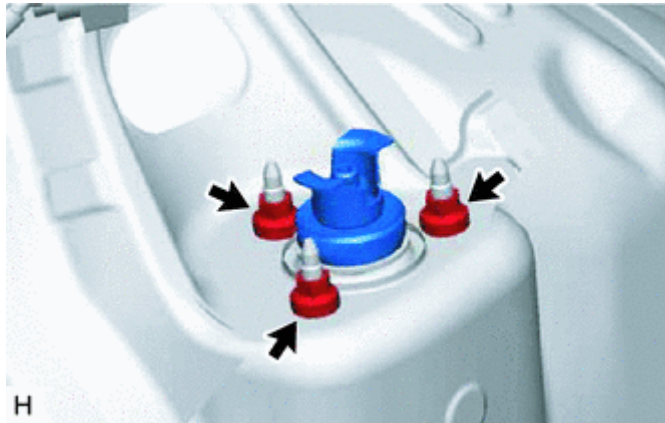

6. REMOVE REAR SUSPENSION SUPPORT ASSEMBLY

a. w/o AVS:

1. Using a 6 mm hexagon socket wrench, secure the rear shock absorber assembly rod and remove the lock nut using a wrench.

NOTICE:

Securely insert the 6 mm hexagon socket wrench to the rear shock absorber assembly rod to prevent damage to the rear shock absorber assembly when removing the lock nut.

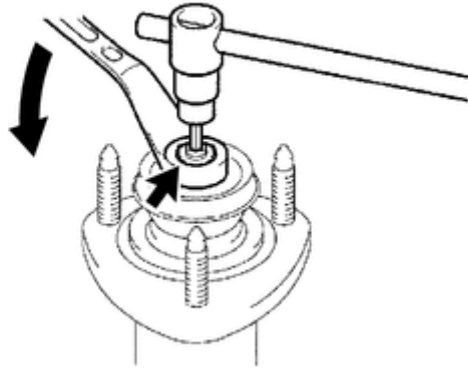

P

2. Remove the rear shock absorber cushion washer, rear No. 1 shock absorber cushion, rear suspension support assembly and rear No. 2 shock absorber cushion from the rear shock absorber assembly.

b. w/ AVS:

1. Secure the rear actuator support bracket of the rear shock absorber assembly between aluminum plates in a vise.

NOTICE:

Do not overtighten the vise.

2. Remove the lock nut and rear actuator support bracket from the rear shock absorber assembly.

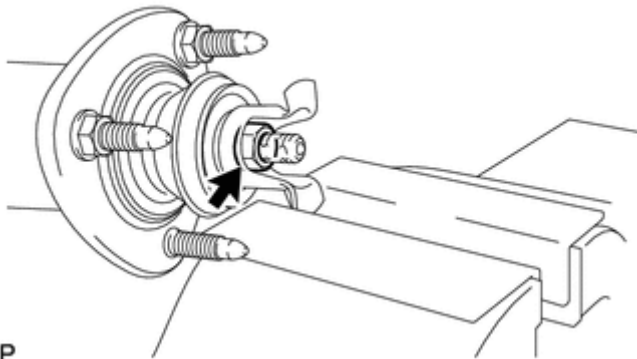

P

3. Remove the rear shock absorber cushion washer, rear No. 1 shock absorber cushion, rear suspension support assembly and rear No. 2 shock absorber cushion from the rear shock absorber assembly.

7. REMOVE REAR NO. 1 SPRING BUMPER

- a. Remove the rear No. 1 spring bumper from the rear shock absorber assembly.

